

Facilities Map

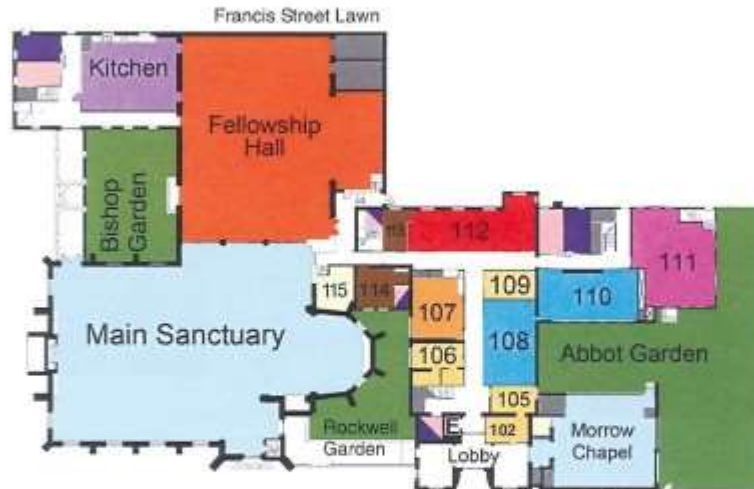

First Floor



- | | |
|-----------------------------------|-------------------------------------|
| 102 Receptionist's Office | 110 The Masterson Room (library) |
| 105 Mailroom | 111 Children's Nursery |
| 106 Parish Administrator's Office | 112 Children's Classroom (Atrium I) |
| 107 Rector's Office | 113 Vesting Room |
| 108 The Smith Room | 114 Vesting Sacristy |
| 109 Finance Office | 115 Sacristy |

Second Floor

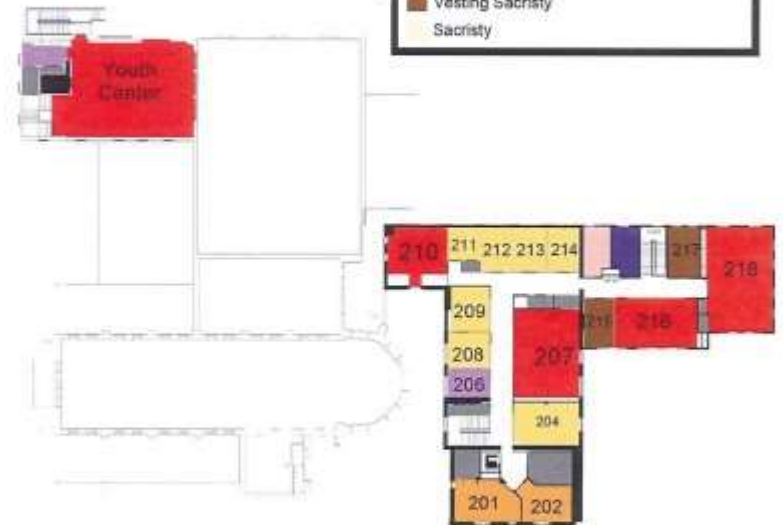

- | | |
|--------------------------------------|---------------------------|
| 201 Curate's Office | 210 Young Adult Classroom |
| 202 Assistant Rector's Office | 211 Librarian's Office |
| 204 Organist/Choirmaster's Office | 214 Music Library |
| 206 Kitchen | 215 Women's Vesting |
| 207 Children's Classroom (Atrium II) | 216 Classroom |
| 208 Family Ministry Office | 217 Men's Vesting |
| 209 Youth Ministry Office | 218 Classroom |

Key

■ Classrooms	■ Storage
■ Meeting Rooms	■ Ladies Room
■ Nursery	■ Mens Room
■ Staff Offices	■ Kitchens
■ Clergy Offices	
■ Vesting Sacristy	
■ Sacristy	